

# TPI-98ETT

## 90 IPERLOTUS TOUCH INDUCTION SOLID TOP - TOUCH



Three-phase induction Solid top, Touch  
Screen 4,3" with 10 power levels. "Energy  
Saving, WiFi and CLOUD". Functions: 2  
timerr. 4x2 zones -glass cm.75x77 (included  
1 Head end filler strip mod.TPA-9)



Construction - Fabricated using CrNi 18/10 AISI 304 grade Stainless Steel  
Scotch-Brite Satin polish Finish, incorporating 2mm thick worktop,  
rounded edges, chromed details and rear splash back. Knobs with  
waterproof grades IPX5 and 4.3" capacitive touch screen. Model -  
Professional Three-phase induction cooking top on cabinet. Ceramic  
glass induction cooking top where you can place a large number of pans.  
It heats the contents only when the pan, that has a magnetic steel  
bottom, is placed in contact with it. Single display for 2 cooking zones  
with power adjustment from 0 to 10 levels, 2 timers maximum 99  
minutes, standard WiFi and CLOUD, designed for connection to an  
external "ENERGY SAVING" system. Maintenance - All serviceable parts  
are accessible by the easy removal of front dashboard. Fittings -  
Appliance is supplied with adjustable feet.

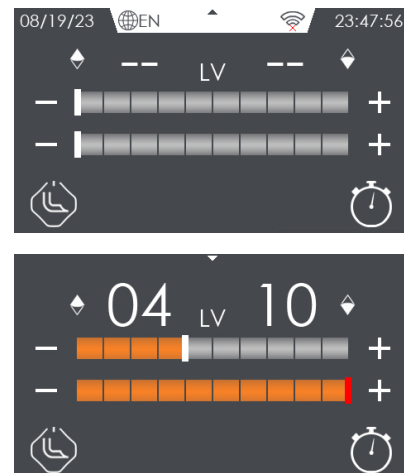

ITALIAN CULINARY ART

The pictures are purely representative. The  
manufacturer reserves the right to modify the  
technical data and models without previous  
notice.

# TPI-98ETT

90 IPERLOTUS TOUCH  
INDUCTION SOLID TOP - TOUCH

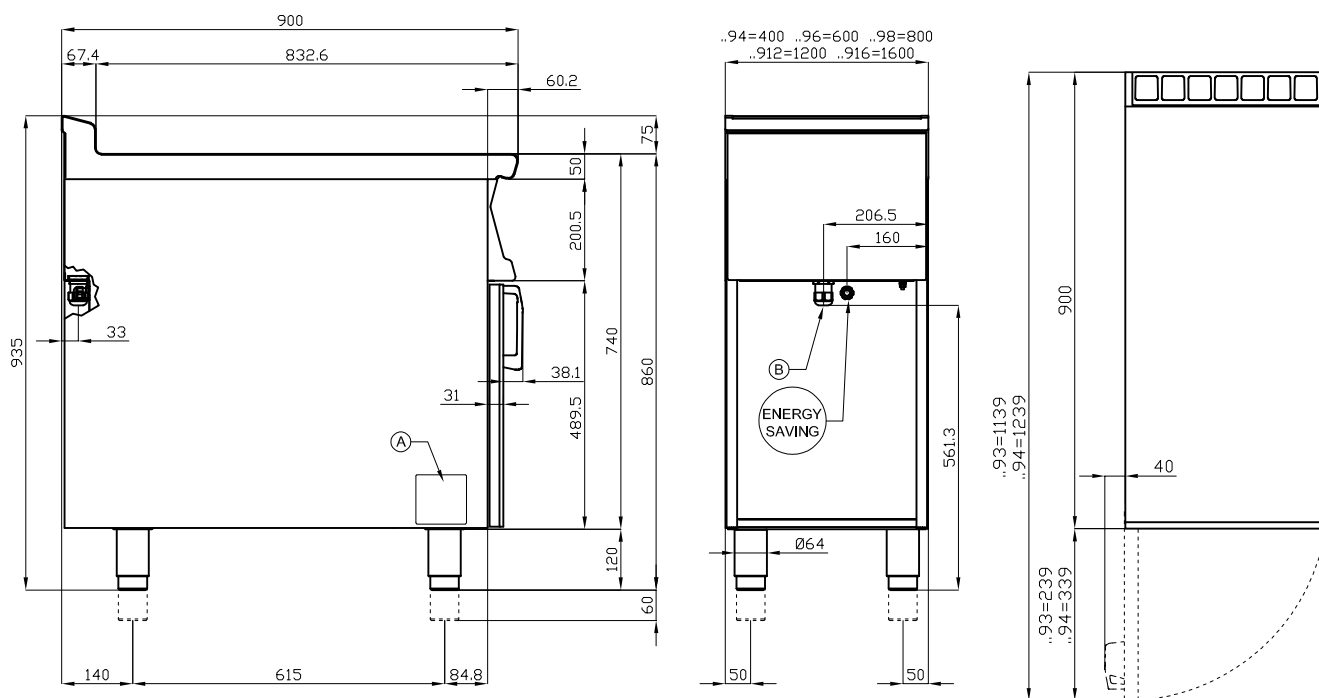

A	Data plate	B	Electrical connection
---	------------	---	-----------------------

MODEL: TPI-98ETT  
 DIMENSIONS: cm. 80x 90x 90h  
 ELECTRIC POWER: 28 kW  
 VOLTAGE: 400V~3N  
 FREQUENCY: 50/60 Hz



kg: 95  
 m<sup>3</sup>: 0.894  
 mm: 830x970x1110

BUY LOTUS BUY ITALY

The pictures are purely representative. The manufacturer reserves the right to modify the technical data and models without previous notice.



LOTUS S.P.A. Via Calmaor, 46  
 31020 San Vendemiano(TV) - Italy  
 Tel. + 39 0438 778020 / 778468  
 Fax + 39 0438 778277  
 www.lotuscookers.it - lotus@lotuscookers.it