

PCID-68ET

ELECTRIC FREELOTUS INDUCTION BOILING UNIT 60

Three-phase induction cooking - 4 zones -
glass cm.75x57 (do not place on ovens or
drawers)

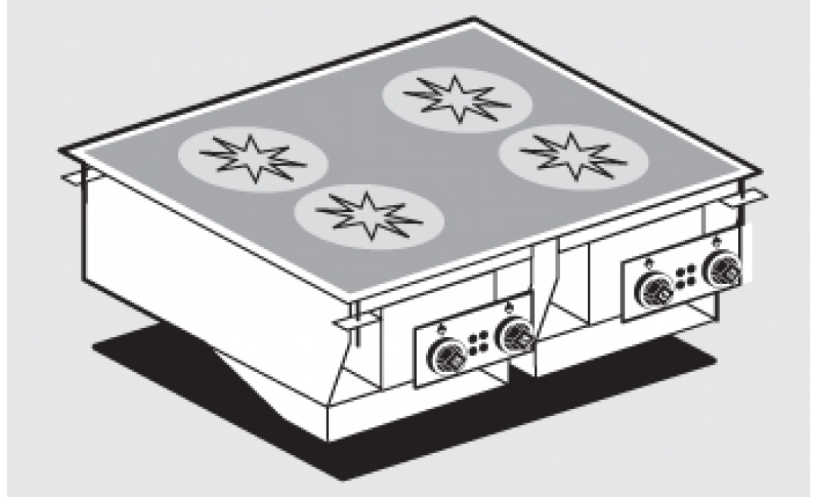

Construction - Fabricated using CrNi 18/10 AISI 304 grade Stainless Steel
Scotch-Brite Satin polish Finish, incorporating 2 mm thick worktop,
chromed details. Model - Professional Induction cooking or Wok Hob.
Ceramic glass top with high output cooking areas, heats only the
content of the pan with magnetic steel base. Standard or digital control
offers accurate adjustment for delicate to high cooking temperatures.
Wok hob suitable for use with steel concave pan. Fittings - Fixing
system.



ITALIAN CULINARY ART

The pictures are purely representative. The
manufacturer reserves the right to modify the
technical data and models without previous
notice.

PCID-68ET

ELECTRIC FREELOTUS
INDUCTION BOILING UNIT 60



Tabella		
Descrizione	A	B
PCID-64ET	400 mm	31,5 mm
PCID-68ET	800 mm	231,5 mm

A	Data plate		B	Electrical connection	
---	------------	--	---	-----------------------	--

MODEL: PCID-68ET
 DIMENSIONS: cm. 80x 60x 42h
 ELECTRIC POWER: 20 kW
 VOLTAGE: 400V~3
 FREQUENCY: 50/60 Hz

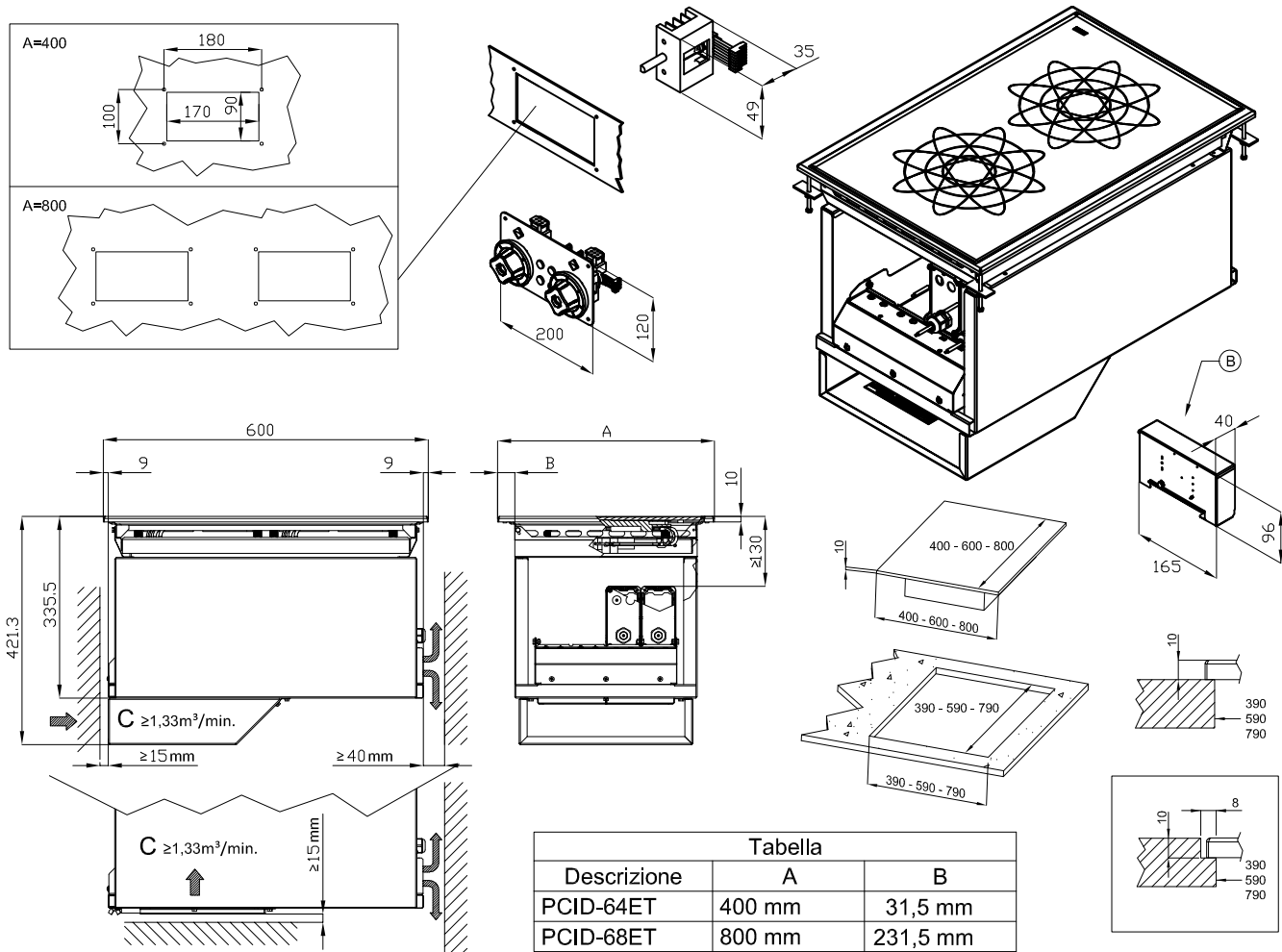

kg: 40
 m³: 0.32
 mm: 1080x630x470

BUY LOTUS BUY ITALY

The pictures are purely representative. The manufacturer reserves the right to modify the technical data and models without previous notice.



LOTUS S.P.A. Via Calmaor, 46
 31020 San Vendemiano (TV) - Italy
 Tel. + 39 0438 778020 / 778468
 Fax + 39 0438 778277
 www.lotuscookers.it - lotus@lotuscookers.it