

# CSD012E

## ELECTRIC FREELOTUS LOW TEMPERATURE OVEN

Low temperature oven with 2 drawers  
GN1/1 max. cm15h, temp: 30÷120°C.  
Electronic control of the time, temperature  
and core probe, HOLD function. DROPIN  
VERSION FOR FREEBLOCK 5\_0.



**CONSTRUCTION:** Tightness chamber with radiused corners. Total thermic insulation with rock or glass wool. Long lasting drawers seals made up of food grade of high heat resistance. Static heating provided by low consumption wire heating element that coils up all the chamber.

Ergonomic and fully built-in drawers handle with magnetic closure.

**FUNCTIONAL FEATURES:** Two adjustable humidity vents. Chamber with safety thermostat.



ITALIAN CULINARY ART

The pictures are purely representative. The manufacturer reserves the right to modify the technical data and models without previous notice.

# CSD012E

ELECTRIC FREELOTUS  
LOW TEMPERATURE OVEN

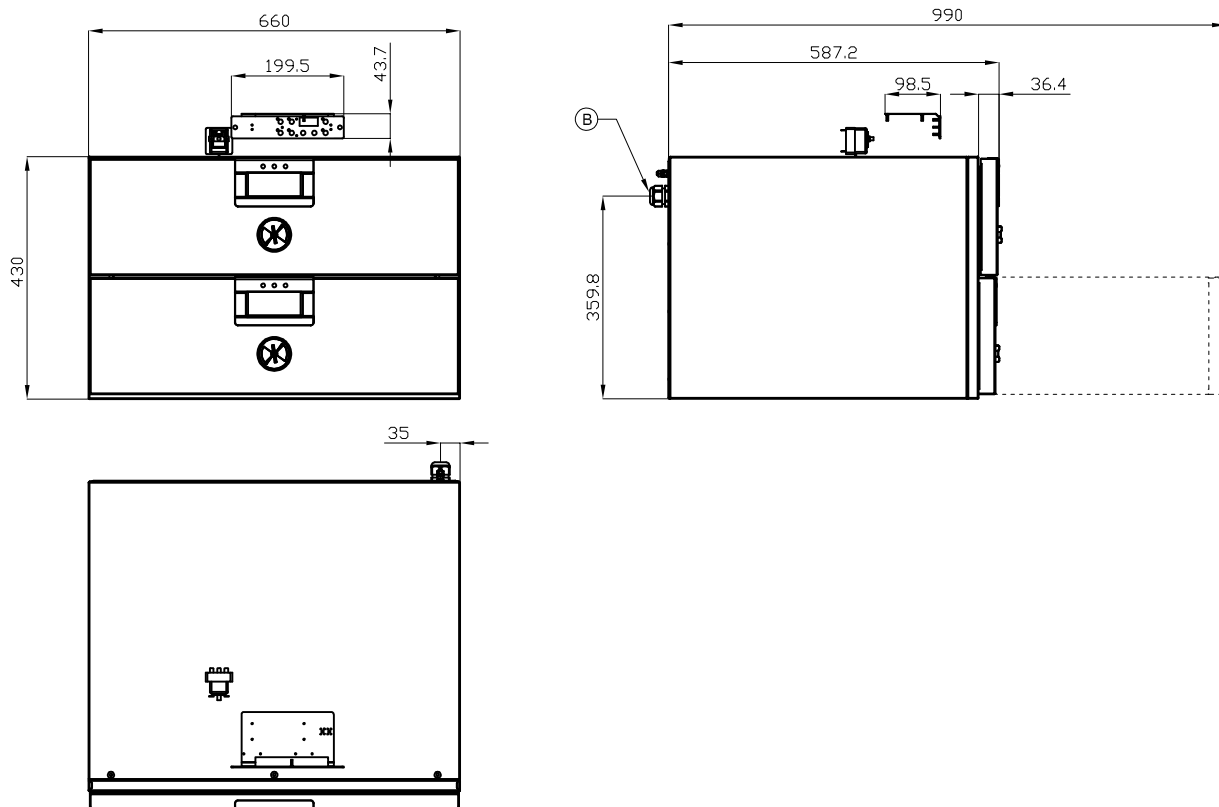

|   |            |  |   |                       |  |
|---|------------|--|---|-----------------------|--|
| A | Data plate |  | B | Electrical connection |  |
|---|------------|--|---|-----------------------|--|

MODEL: CSD012E  
DIMENSIONS: cm. 80x 61x 51h  
ELECTRIC POWER: 1 kW  
VOLTAGE: 230V~  
FREQUENCY: 50 Hz



kg: 55  
m<sup>3</sup>: 0.441  
mm: 900x700x700

BUY LOTUS BUY ITALY

The pictures are purely representative. The manufacturer reserves the right to modify the technical data and models without previous notice.



LOTUS S.P.A. Via Calmaor, 46  
31020 San Vendemiano(TV) - Italy  
Tel. + 39 0438 778020 / 778468  
Fax + 39 0438 778277  
www.lotuscookers.it - lotus@lotuscookers.it